

**NOTE:**

- 1.0 THIS DRAWING IS TO BE READ IN CONJUNCTION WITH ALL RELEVANT DRAWINGS AND SCHEDULES
- 2.0 ALLOWABLE BEARING PRESSURE TO ALL FOUNDATIONS IS 75kPa. CONTRACTOR TO ALLOW FOR TESTING.
- 3.0 CONCRETE STRENGTH TO BE AS FOLLOWS: FOOTINGS, SURFACE BEDS, - 20MPa, SUSPENDED SLABS, BEAMS - 25MPa
- 4.0 COVER TO ALL REINFORCEMENT SHALL BE AS FOLLOWS: FOUNDATIONS - 50mm, BEAMS - 30mm, SLABS - 25mm.
- 5.0 NO CONCRETE SHALL BE POURED WITHOUT THE ENGINEER'S APPROVAL

10mm ISOLATION JOINT WITH SOFT BOARD OR EQUIVALENT APPROVED JOINT FILLER WITH TOP 25mm RAKED OUT AND REPLACED BY POLYURETHANE OR APPROVED JOINT SEALANT

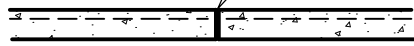

**CONSTRUCTION JOINT (Cs.J)**  
1:25

6mmx25mm DEEP SAW CUT JOINT WITH POLYURETHANE OR APPROVED JOINT SEALANT

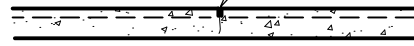

**CONTRACTION JOINT (C.J)**  
1:25

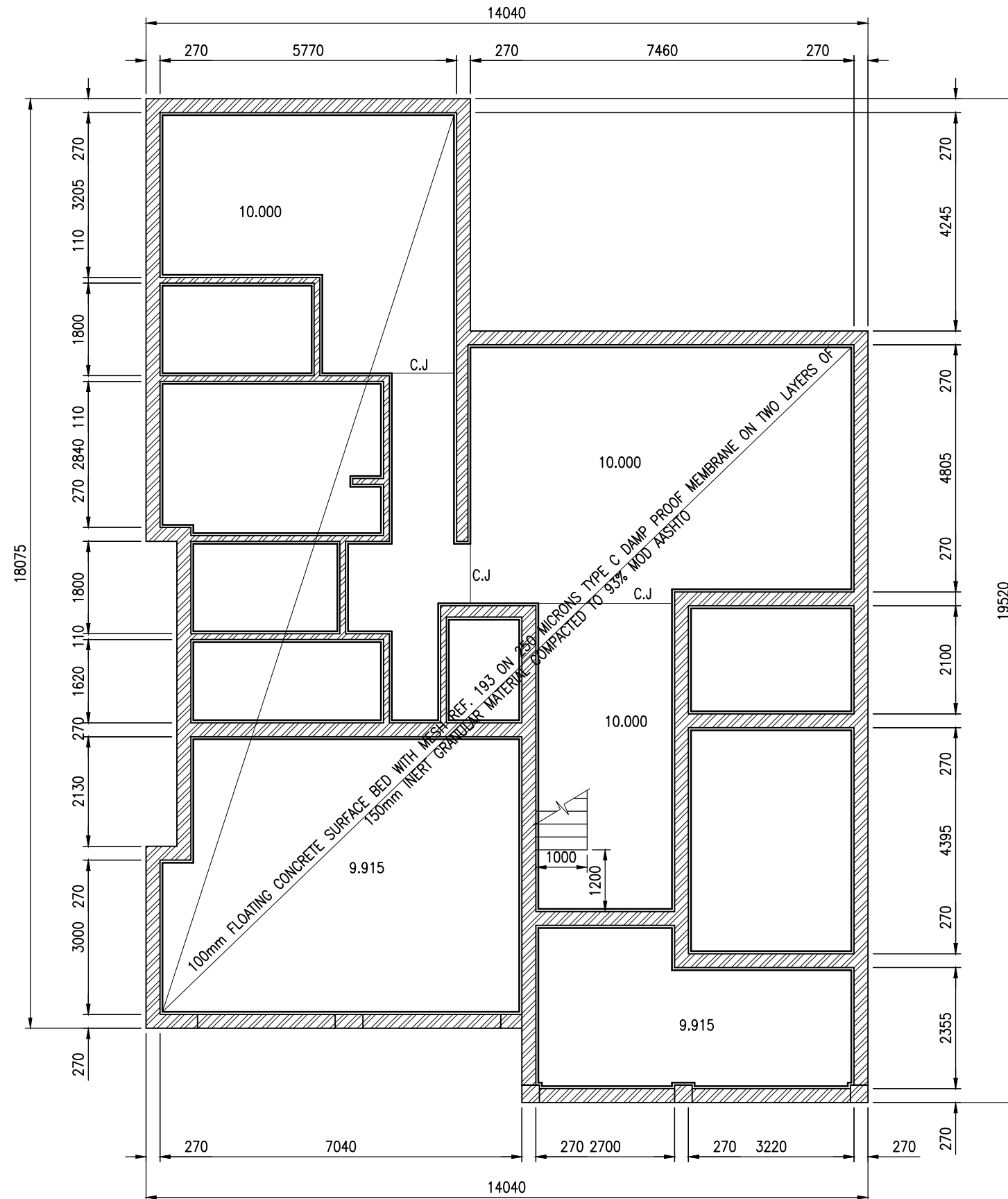

**GROUND FLOOR LAYOUT**  
1:100

HOUSE MULEYA  
 PROPOSED MAIN HOUSE ON  
 ERF 6520 BONZA VIEWS, EAST LONDON  
 DWG No. 1910-02  
 GROUND FLOOR LAYOUT  
 JUNE 2019